

CONVERGE
Together



**CELEBRATING
170 YEARS OF
LIFE CHANGE**

2026

BREAKOUT SESSIONS



BREAKOUT SESSIONS

TUESDAY, JUNE 23 • SESSION I

ROOM	SESSION
1201	<p>Coaching for Change: The Dirty Secret for Good Coaching, <i>Danny Parmelee</i></p> <p>Coaching has become one of the most overused, and least defined, words in ministry. Its constant use has blurred its meaning and weakened its impact. In this session, Danny Parmelee cuts through the clichés to expose the dirty secret behind truly effective coaching. Drawing from years of hands-on experience, Danny will share a practical, repeatable framework you can begin using immediately with leaders you coach. Whether you're new to coaching or have been doing it for years, this session will help you coach with greater focus, purpose, and measurable impact.</p>
1211	<p>Don't Lose Your Mate to Ministry: How to Stay Emotionally Connected to One Another, <i>Rod Hairston</i></p> <p>In the high-stakes world of ministry, it is easy for one's marriage to be sacrificed on the altar of busyness. This workshop provides a safe and honest space for pastors and their spouses to hit the "pause" button on church demands and prioritize their marriages. The session will explore the five keys to reigniting intimacy to help couples go from coexisting to flourishing together.</p>
1305	<p>The Unknown Church: Moving Unknown Online Viewers to Engaged Known Members, <i>Jill Duroseau</i></p> <p>New Barna research reveals the average churchgoer attends only 1.6 Sundays per month. But where are they the other Sundays—and what is happening to their spiritual journey? And what about all the people behind your online numbers—how are you discipling them? In this session, Jill Duroseau will introduce "care, capture, categorize, connect," a four-step strategy for moving people from unknown to known, fully engaged church members—unlocking growth, generosity, discipleship, and more of the next generation.</p>
2001	<p>La Iglesia Hispana: Retos y Oportunidades (Un Taller en Español), <i>Abram Delgado and David Uribe</i></p> <p>La iglesia hispana vive en una tensión constante. Esta sesión explorará las realidades que enfrentamos—culturales, generacionales, y espirituales—y como Dios está abriendo puertas estratégicas para plantar y multiplicar. No se trata sólo de sobrevivir sino de discernir el momento y responder con fé y visión.</p>
2111-12	<p>Protecting the Flock: Building a Strong Church Safety and Security Culture, <i>Jason Stewart</i></p> <p>Churches are called to be places of worship, community, and peace, but they must also be prepared to protect those they serve. In this session, Jason Stewart will share practical strategies for building a strong safety and security culture that supports the mission of the church while creating a safe environment for congregants, staff, and visitors. Drawing from real-world leadership experience in large and small ministry environments, Jason will discuss how to develop effective security teams, implement scalable safety systems, and foster awareness across the entire church community. Attendees will gain practical insights on moving beyond equipment and volunteers to create a culture in which safety, preparedness, and ministry work together.</p>
2101	<p>Who Is Converge?, <i>Ken Nabi</i></p> <p>If we fail to learn from the past, we are doomed to repeat its mistakes. When we understand the history of Converge as a gospel movement of churches, we can ensure that our originating distinctives continue to inform tomorrow's church health. This session will review Converge's history as a pietistic movement marked with an irenic spirit. It will also offer suggestions for future movement values so Converge churches can engage the next generation.</p>
2109-10	<p>Rural Church Growth: Thriving in a Small Town, <i>Troy Gentz</i></p> <p>Your town does not have to be big to have a big impact for the Kingdom. Small-town churches often have big advantages. Join Troy Gentz in exploring how small-town churches can grow, thrive, and help transform communities.</p>

BREAKOUT SESSIONS

TUESDAY, JUNE 23 • SESSION I

ROOM	SESSION
2311	<p>Why Most Churches Aren't Reaching the Lost—and How Yours Can, <i>Joe Boyd</i></p> <p>Churches aren't just plateauing—they're declining, and fewer people are coming to Christ. If nothing changes, the future trajectory is clear. But it doesn't have to stay that way. In this urgent and practical breakout session, Joe Boyd—director of the Wheaton College Billy Graham Center Church Evangelism Institute and lead pastor of Grace Fellowship—will show you how to reverse the trend and build a true conversion community in which everyday people share their faith and lives are transformed. You'll gain a clear vision, simple tools, and a proven pathway to move from decline to gospel momentum.</p>
2005-6	<p>From Seed to Movement: Thinking about Church Planting and Multiplication, <i>Kevin and Amy Drehmel</i></p> <p>Every church, movement, and aspect of Kingdom work begins as a seed—a God-given burden placed in the hearts of ordinary people willing to say yes. But how does that seed grow into something healthy, lasting, and multiplying? In this honest and practical session, Pastors Kevin and Amy Drehmel will share lessons from the front lines of church planting, leadership, family, suffering, and ministry. Drawing from their journey of planting Harvest Church, they will unpack how to discern God's call, count the cost, build a healthy foundation, develop leaders, engage your community, and create a culture in which disciples, leaders, and churches multiply. Come be challenged to build something that doesn't stop with you—but outlives you for the glory of God.</p>
2007-8	<p>Going Local to Go Global, <i>Ivan Veldhuizen</i></p> <p>"Going" is a critical role of every believer and every church. How do we do that well? This session will incorporate proven strategies to engage your church across the street and around the world. Influence always begins where we are and can then be expanded far beyond our local reach. You will leave inspired, challenged, and equipped to begin a transformational journey for your congregation to be effectively engaged in your Jerusalem, Judea, Samaria, and ends of the earth.</p>
2009-10	<p>Peacebuilding Leadership in a Divided World, <i>Jim Eaton</i></p> <p>We live in a time of intense polarization: people seem to be dividing over cultural issues, political issues, and ideological issues. And it's affecting your church and community. Yet Jesus still calls us to peacebuilding. In this session, Jim Eaton will coach you through four steps to effectively understand and engage with your neighbor. You will interact with proven approaches that will enable you to reduce conflict and misunderstanding and to build peace and flourishing in your ministry context.</p>
2105-6	<p>Developing and Deploying Dream Disciples, <i>Jason Allison</i></p> <p>What kind of disciples does your church need to deploy to reach your community? Jesus clearly called us to make disciples, but more often than not, we make church attendees. This session will explore what it looks like to move the finish line and change the scorecard so we can build a strong disciple-making culture in our churches.</p>
2107-8	<p>Generosity and Gen Z: Stewarding the Next Generation of Givers, <i>Mark Venti</i></p> <p>Join Overflow for a curated networking lunch designed for church leaders who are passionate about discipling the next generation in tithing, generosity, and stewardship. As Gen Z and younger Millennials engage with money, church, and technology differently from any generation before them, the church has a powerful opportunity to meet them where they are. This session will create space for meaningful connection and conversation around discipling generosity as an act of worship, not just a transaction; teaching tithing in a digital-first world; and leveraging technology to remove friction and increase engagement. It will also cover practical strategies churches are using to activate lifelong generosity. Come connect with peers, share what's working, and explore how technology can serve the mission of raising joyful, generous disciples.</p>
2011-12	<p>Steward Your Team, <i>Diana Mescher</i></p> <p>Watch God build His Kingdom not just through your ministry, but also in your team and staff. Jesus showed us how! What will you do with the people and teams you've been entrusted with? In this session, Diana Mescher will encourage you with practical principles and wisdom from God's Word to start applying to your leadership and ministry.</p>
MAIN ROOM	<p>Preaching, <i>Keith Battle</i></p> <p>This session will offer practical tools and the spiritual necessities to faithfully and effectively preach God's Word.</p>

BREAKOUT SESSIONS

WEDNESDAY, JUNE 24 • SESSION 2

ROOM	SESSION
1201	<p>Using AI to Serve Your Church: Moving from Research Tool to Shepherding Partner, <i>Chuck Scoggins</i></p> <p>Most of us are using AI as a smarter search bar: ask a question, get an answer. It's useful, but it is still just a tool you have to pick up and operate. This session is about the leap most pastors have not made yet, from AI as a research tool to AI as a ministry partner that does real work recruiting volunteers, welcoming guests, extending your sermon into a week of discipleship, building tools your church could never afford to commission, and watching your data so no one slips through the cracks. Built around a simple charge from John 21 and organized into four movements, this is a practical, advanced session with 10 uses you can start putting to work this week.</p>
1211	<p>Intentional Movement: Moving from Guest to Committed Member, <i>Dr. Michael Henderson</i></p> <p>This session will discuss the philosophy of assimilation and how to develop and maintain systems and processes to sustain growth and discipleship beginning at the altar. You will obtain practical training on establishing an effective orientation and new-member assimilation connecting points to formally assimilate guests, converts, and new members in your church and help them get connected and serve. You'll learn the philosophy of volunteerism and how to employ biblical and practical principles to empower people in areas of their gifting and skill sets to lead in your ministry.</p>
1305	<p>Leading with a Shared (Disciple-Multiplying) Vision, <i>Shane Stacey</i></p> <p>Vision isn't hard—but cultivating a shared vision fueled by disciple-making clarity sure can be. This session will explore eight common vision problems that trip up leaders. You'll be introduced to a few powerful tools to overcome them so your leadership is heading in the same direction, holy risk-taking is awakened in your congregation, and a greater collective gospel impact is experienced in your local community.</p>
2001	<p>Faithful Presence: Pastoral Care amid Sexual Brokenness and Identity Questions, <i>Nate Wagner</i></p> <p>Pastors and ministry leaders are increasingly called to walk with individuals and families navigating questions of gender identity, sexuality, and deep relational pain. This session will equip pastors to offer compassionate, grace-oriented care while remaining firmly rooted in a historic Christian view of gender, marriage, and sexuality. Moving from issues to be solved or debated to be won, the session will emphasize presence, wisdom, and faithful discipleship. Using three pastoral care paradigms designed to guide counseling and care in these sensitive areas, the session is designed to help pastors address deeper heart dynamics, reduce shame, and invite hurting individuals into the transforming grace of Christ. Holding truth and grace together, this session will offer practical tools for shepherding with clarity, courage, and Christ-centered hope.</p>
2111-12	<p>Why the Great Commission Isn't Finished without the Deaf, <i>Converge Deaf Catalyst Team</i></p> <p>Why are Deaf people among the least-reached, yet in nearly every community? In this session, the Converge Deaf Catalyst Team will deepen your understanding of Deaf people and culture and the church's role in the Great Commission. With 350–400 sign languages worldwide, Deaf people represent hundreds of unreached people groups—often overlooked and underserved—yet many live in your city and neighborhood. This session will explore why Deaf communities remain unreached, why ministry with (not just for) Deaf people matters, and how God is raising Deaf leaders to disciple others. You'll also gain practical next steps for your church—local to global. By bringing together the Great Commission, crosscultural ministry, and leadership development, this session will broaden your vision and challenge your assumptions.</p>
2101	<p>Becoming a Pastor of Your City, <i>Daniel Flores</i></p> <p>This session will cover collaborative outreach to the marginalized by discussing justice, poverty, and the gospel.</p>
2109-10	<p>When the Economy Shifts: Risks and Realities Facing Churches, <i>Katie Sharon and Chris Highfill</i></p> <p>This session will provide a candid look at the economic forces reshaping the giving landscape—and what church leaders need to understand to protect the financial health of their congregations before crises arrive.</p>

BREAKOUT SESSIONS

WEDNESDAY, JUNE 24 • SESSION 2

ROOM	SESSION
2311	<p>Build the Bench: How to Raise Leaders before You Need Them, <i>Ronnie Bunton</i></p> <p>Most churches aren't lacking leaders—they're lacking a clear and intentional way to develop them. The future of the church will be built not on who we can recruit but on who we are willing to raise. This session is about shifting from filling gaps to forming people—building a leadership bench that is deep, durable, and ready.</p>
2005-6	<p>Effective Church Marketing: Stop Spamming, Start Connecting, <i>Libby Littrell and Cory Edwards of ArtSpeak Creative</i></p> <p>You didn't step into leadership to spam people or become an influencer. You have a call to communicate, and to do it well. If you've felt pressure to get louder, you're not alone. Feeds are crowded, inboxes are tired, and people scroll past well-intentioned noise. The answer isn't shouting; it's speaking meaningfully so the right people recognize themselves in your story and take a next step toward a better life.</p>
2007-8	<p>Becoming a Sending Church, <i>Chaz Nichols, Drew Robertson, and Steve Valentine</i></p> <p>This session will explore practical ways for your church to move from supporting to sending here, near, and far.</p>
2009-10	<p>The Future of Theological Education, <i>Dr. Peter Vogt and Josh Manfred</i></p> <p>Theological education is in a time of transition. Old models are no longer seen as relevant, and new models are being explored. This session will explore the state of theological education today and highlight new initiatives and developments to ensure leaders of the future are prepared for ministry in an ever-changing context.</p>
2107-8	<p>Formational Shift: Reimagining Church Facilities for Discipleship and Worship, <i>Josh Gregoire</i></p> <p>Buildings are never neutral. Every space decision your church makes is quietly shaping the faith of the people inside it, for better or for worse. But what if your facilities could do more than house ministry? What if they could actively form disciples? This session will unpack the Formational Shift framework, a practical and theological approach to designing church spaces that advance your mission rather than work against it. Through biblical principles, real-world research, and actionable tools, you will gain fresh vision and concrete next steps to align your environments with the mission Jesus has given your church and the people He has called you to reach.</p>
2105-6	<p>Increasing Your Generosity Footprint, <i>Kent Adcock</i></p> <p>This session will relay information on how churches and regions can benefit from increased giving, whether present or future giving. It will also address how church members and partners can make qualified charitable distributions from their IRAs as part of their required minimum distributions.</p>
2011-12	<p>Redeemed and Restored: Collaborative Outreach to the "Least of These" (Poor, Marginalized, and Justice Involved), <i>Rev. Dr. Jonathan Queen</i></p> <p>You can't redeem what you reject! This session will focus on the overlooked mission field in the backyard of most churches. You'll engage in critical dialogue on how to minister to the most vulnerable populations and provide services and programs that help redeem and restore at-risk adults and youth. Dr. Jonathan Queen will provide an expert-by-experience approach to the crossroads of justice and ministry.</p>
MAIN ROOM	<p>Getting to the Heart of the Matter: From Chaos to Calm, <i>Coletta Smith</i></p> <p>If you're a pastor's wife or woman in ministry, you often find yourself in the middle of others' tornadoes. People come to you in the midst of their own chaos, wanting you to help them find clarity and hope and to see God's leading toward their next steps. This requires you to be able to get to the heart of the matter and help them distill the core challenges and the complicated emotions that are trying to drive their decisions. During this session, you'll be equipped with a solid, memorable tool, "PEEL" (think peeling back an onion), which will help you get to the heart of the matter that is swirling around in the chaos of the lives God has called you to shepherd.</p>

SESSION LEADERS

Kent Adcock

Vice President of Development, Converge

As vice president of development at Converge, Kent Adcock brings value in helping church members create an increased generosity footprint, to include regular giving paths as well as estate planning for wealth transfer. His past association resulted in considerable increases in sustainable funding for churches and heirs alike.

Jason Allison

Director of Church Strengthening, Converge MidAtlantic

Jason Allison serves as the director of church strengthening for Converge MidAtlantic, where he is dedicated to empowering churches and leaders through strategic visioning and support. He is the founder of the Church Talk Project and is a VisionDay consultant for 95Network. Additionally, Jason serves as church coach for Chemistry Staffing. With a rich background in pastoral leadership across congregations ranging from 45 to 2,500 attendees, Jason works with pastors and churches in defining and realizing their missions and visions within their unique cultural contexts. In his role at Converge MidAtlantic, he focuses on training and deploying coaches, supporting churches and pastors in times of crisis and transition, and creating tools and resources to help strengthen churches.

ArtSpeak Creative

ArtSpeak Creative is a creative agency for life-changers that believes the most important message in the world deserves to be heard. Specializing in strategic marketing for churches, ArtSpeak helps leaders move past the noise of modern culture to build genuine, lasting connections and ultimately reach more people.

Keith Battle

Senior Pastor, Zion Church

Keith Battle is the senior pastor of Zion Church, which has locations in Woodbridge, Virginia; Fort Washington, Maryland; Landover, Maryland; and Greenbelt, Maryland.

Joe Boyd

Lead Pastor, Grace Fellowship, and Director of the Wheaton College Billy Graham Center Church Evangelism Institute

Joe Boyd serves as director of the Wheaton College Billy Graham Center Church Evangelism Institute, where he equips pastors and churches across the country to become evangelistic, multiplying communities. He is also the lead pastor of Grace Fellowship in Brooklyn Park, Minnesota—one of the most evangelistic and reproducing churches in America—where over 80% of adults are engaged in small groups and new churches are launched annually.

Ronnie Bunton

Leadership Development Director, Rock Point Church

Ronnie Bunton serves as the leadership development director at Rock Point Church in Queen Creek, Arizona, where he leads the vision and strategy for developing leaders at every level of the church. Ronnie is passionate about building leaders from within and creating sustainable systems that form both character and competency for long-term ministry impact.

Converge Deaf Catalyst Team

The Converge Deaf Catalyst Team exists to see Deaf people in every people group have access to the gospel, discipleship, and leadership development—in their own languages and cultures. Passionate about the Great Commission, the team works to mobilize churches, leaders, and global partners to engage Deaf communities both locally and internationally. Grounded in the conviction that Deaf people are not a “ministry project” but are vital partners in God’s mission, the Deaf Catalyst Team advocates for ministry that is led by Deaf leaders, shaped by Deaf culture, and sustained through long-term relationships. The team believes the Great Commission will not be complete until Deaf people everywhere have had a genuine opportunity to meet, know, and follow Jesus.

Abram Delgado

Pastor, Casa de Oración, and Associate Director of Latino Church Strengthening, Converge MSC

Abram Delgado planted and serves as pastor of Casa de Oración. He is also the associate director of Latino church strengthening at Converge MSC and participates in several programs for Converge, including church planting assessments and Latino conferences.

SESSION LEADERS

Kevin and Amy Drehmel

Pastors and Church Planters, Harvest Church

Pastors Kevin and Amy Drehmel are the founding leaders of Harvest Church in Big Lake, Minnesota, where they are passionate about making disciples, developing leaders, and building a multiplying church. With more than 20 years of ministry experience, Kevin serves as lead pastor, bringing a deep love for biblical preaching, disciple-making, and church planting, while Amy serves in leadership, discipleship, communication, hospitality, and community engagement. Together they also founded The Compassion Connection, a non-profit serving foster, adoptive, and kinship families across Central Minnesota. Married for 25 years, they are parents, grandparents, and foster/adoptive parents who are committed to seeing lives transformed, leaders raised up, and churches multiplied for the glory of God.

Jill Duroseau

CEO, Know Your Cross

Jill Duroseau built her career in marketing at Johnson & Johnson and Gillette learning one thing: the organizations that truly care about and know their people capture and keep them. That conviction led her out of the boardroom and into the faith space to use that same understanding and intelligence to help church leadership capture people for Christ and keep them.

Jim Eaton

Co-director of Biblical Diversity, Converge, and Founder and CEO, Peacebuilders Table

Pastor Jim Eaton shares a deep commitment to biblical diversity, drawing on nearly three decades of experience in church planting across South Africa, Germany, and the Washington, D.C., area. His work has provided him with firsthand insight into the challenges and opportunities of leading a diverse congregation. Recognizing the polarization that can hinder meaningful dialogue in today's society, Pastor Jim focuses on building bridges that bring people together, addressing deep-seated pain while fostering genuine connections. His vision is to influence the entire culture of the Converge movement, ensuring that every part of it reflects the beauty of a diverse world. Pastor Jim believes that embracing biblical diversity is crucial for the growth and vitality of the church, especially for future generations.

Daniel Flores

Lead Pastor, R Church

Daniel Flores is the lead pastor of R Church, a bilingual church he planted with Converge in Elgin, Illinois. He serves as the community relations and crime prevention specialist for the Elgin Police Department and is the varsity soccer coach at Elgin High School. Daniel also equips Latino pastors around the country and Latin America as the lead Hispanic trainer for the Billy Graham Evangelistic Association.

Troy Gentz

Lead Pastor, Freshwater Community Church

Troy Gentz is a pastor at Freshwater Community Church in the small town of Paw Paw, Michigan. Troy has a passion for small towns and the impact churches can have in them.

Josh Gregoire

Director of Development, Aspen Group

Josh Gregoire serves as director of development at Aspen Group, partnering with churches across the country to help leaders think strategically about how their facilities shape the people inside them. Having served in local church ministry as both an elder and a discipleship pastor, Josh brings a deep appreciation for the challenges and opportunities pastors face today. His work challenges church leaders to see their buildings not as neutral containers but as formational environments, ones that either advance or quietly work against the mission of making disciples.

Rod Hairston

Senior Pastor, Messiah Community Church, and Co-director of Biblical Diversity, Converge

Rod Hairston, M.A., is a church-planting pastor and an executive marriage coach who helps couples build healthy marriages and thriving families. He has served in pastoral ministry for more than 20 years and brings over 30 years of experience as an executive marriage coach working with high-performing couples in professional sports and business. Rod helps couples experience breakthroughs by drawing on biblical principles and practical coaching strategies that strengthen communication, deepen connection, and support long-term relationship success.

SESSION LEADERS

Dr. Michael Henderson

Senior Pastor, New Beginnings Church, and Executive Vice President of National Ministries, Converge

Rev. Dr. Michael L. Henderson Sr. is the senior pastor of New Beginnings Church in Matthews, North Carolina, which he co-founded with his wife, Rev. Dr. Twanna Henderson. He serves as the executive vice president of national ministries for Converge. He is vice-chair of the Wheaton College Billy Graham Center African American Church Evangelism Institute's oversight team and executive team, and serves as a coach developer. He earned a Bachelor of Arts in communication and theology at International Seminary in Orlando, Florida. In October 2009, he received an honorary Doctor of Divinity from St. Thomas Christian University. He earned a Master of Arts in organizational change in ministry and leadership from Wheaton College in 2023.

Chris Highfill

Lead and Founding Pastor, Grace River Church, and Director of Church Planting, Converge MSC

Chris Highfill is the lead and founding pastor of Grace River Church in St. Peters, Missouri, and is the director of church planting for Converge MSC.

Josh Manfred

Program Director of Competency-Based Theological Education, Bethel Seminary

Josh Manfred is the program director for Bethel Seminary's new competency-based theological education programs. Prior to serving at Bethel Seminary, he served in creative access missions contexts in East Africa as well as in urban church ministry in the Twin Cities. He holds an M.Div. from Bethel Seminary.

Diana Mescher

Bible Teacher, Aspire Women's Ministry

With over a decade of leading in local church ministry and supporting church leaders around the globe, Diana Mescher has wisdom, insight for ministry, and passion for people that spark hope and faith in audiences of all ages. Diana completed her M.Div. at Fuller Theological Seminary. She is a Bible teacher, shepherd, author, retreat speaker, requested consultant, board vice president, and encourager.

Ken Nabi

Regional President, Converge Great Lakes

Ken Nabi serves as regional president of Converge Great Lakes. Since 2016, he has helped start and strengthen churches across Wisconsin and Michigan's Upper Peninsula. Previously, Ken spent 21 years on staff at Community Church in Fond du Lac, Wisconsin. He has an M.A. in counseling psychology from Trinity Evangelical Divinity School and has completed doctoral coursework in transformational leadership at Bethel University. Ken serves nationally as president of the Converge regional presidents and has become a national voice for Converge and its pietistic history. Ken sits on the Bethel University board and is the author of *Leading Through and Preparing for Pastoral Failure*. He is known for his gospel-centered leadership and pastoral insight.

Chaz Nichols

Regional Director for Asia, Converge

Chaz Nichols has served with Converge International Ministries for nearly three years as regional director for Asia. Prior to his time with Converge, he was director of missions for a large Converge church in the Minneapolis area.

Danny Parmelee

Regional President, Converge MSC

Danny Parmelee is regional president of Converge MSC and a longtime practitioner in church planting and leadership development. He planted and led a multisite, multiethnic church in Milwaukee and has since focused much of his work on coaching pastors and planters through the real challenges of ministry. Danny has also developed several software tools for leadership development, including RevCoach, which is used by thousands of pastors and church planters. He is passionate about coaching that is practical, relational, and sustainable.

SESSION LEADERS

Rev. Dr. Jonathan Queen

Senior Pastor, Greater First Baptist Church of Pleasant Plains in Washington, D.C.

Rev. Dr. Jonathan Queen serves as senior pastor of Greater First Baptist Church of Pleasant Plains in Washington, D.C. He has a Bachelor of Science in Bible from Lancaster Bible College, a Master of Divinity from Lancaster Theological Seminary, and a Doctor of Ministry from Regent University. Rev. Dr. Queen is also an award-winning author of six books, a motivational speaker, an at-risk-youth counselor, a facilitator, and an expert in the fields of mentoring and reentry. He and his wife, Rev. Lenia Queen, launched New Mindz Ministries, Inc., a non-profit organization that provides education, mentoring, life skills training, mental health services, and resources for at-risk youth and adults and returning citizens.

Drew Robertson

Director of Regional Collaboration, Converge

Drew Robertson and his wife, Sarah, have served with Converge International Ministries for the past 15 years. They lived in the Middle East for 10 years working alongside the local church in evangelism and discipleship ministries. Drew currently serves as the director of regional collaboration for Converge International Ministries. His team works alongside Converge regional leadership to equip, mobilize, and develop the local church for gospel advancement among the nations.

Chuck Scoggins

Marketing Coach, INMARKCO

Chuck Scoggins has dedicated more than 20 years to serving churches as a coach, as a consultant, and in the trenches as a communications director. His passion is helping churches leverage technology and communication tools to fulfill their God-given missions.

Katie Sharon

Vice President of Enterprise Strategy, Wesleyan Investment Foundation

Katie Sharon is vice president of enterprise strategy at Wesleyan Investment Foundation.

Coletta Smith

Founder and Director, Alongside Ministry Wives

Coletta Smith is founder and director of Alongside Ministry Wives, a ministry that provides tools and community for pastors' wives and women in ministry around the world. She is passionate about getting to the important stuff in conversations and seeing women in ministry embrace their callings with courage. Over 33 years of vocational ministry, she has been a public school teacher, an event planner, an artist manager for a non-profit, and a homeschool mom—all while navigating the obstacles and opportunities of being a pastor's wife.

Shane Stacey

Co-founder, Clarity House

Shane Stacey is co-founder of Clarity House, where he has invested nearly three decades helping churches and networks gain clarity that creates momentum—building disciple-making cultures that multiply leaders and new gospel expressions. He serves on the leadership team of River City Church in Minneapolis. Previously, Shane served as executive director of Denominee, helping more than 40 denominational and network teams lead with greater clarity and alignment. He also served on the national team of the Evangelical Free Church of America coaching leaders to multiply disciple-making movements.

Jason Stewart

Director of Safety and Security, First Baptist Church of Glenarden

Jason Stewart is the director of safety and security at First Baptist Church of Glenarden, where he leads safety operations across multiple campuses and oversees a team dedicated to protecting thousands of congregants, students, and staff daily. With more than 15 years of leadership experience in security, public service, and organizational leadership, Jason has served in roles including town manager for Camden, Delaware, and senior supervisor supporting security operations for the U.S. Department of State. A U.S. Army Reserve veteran and former military police team leader, he brings a service-driven leadership approach focused on preparedness, collaboration, and community engagement. Jason holds an M.B.A. in organizational leadership and is passionate about helping churches build cultures of safety that support and strengthen their mission.

SESSION LEADERS

David Uribe

Pastor, Iglesia Local, and Associate Director of Church Planting, Converge MSC

David Uribe planted and is the pastor of Iglesia Local. He is also associate director of church planting at Converge MSC, where he walks alongside church planters through coaching, conversations, and practical resources. He is passionate about the Latino community, the next generation, and helping leaders thrive not just in ministry but also in life.

Steve Valentine

Director of Training and Deployment, Converge

Steve Valentine and his wife, Jenny, served as missionaries in Poland from 2015 to 2023. During their time in Poland, they focused on disciple-making and church planting as well as developing a team of missionaries across multiple Eastern European countries. The Valentine family relocated to the central Florida area but continue to serve in a variety of leadership roles within Converge. Steve continues to provide support for Converge's 15:5 West Initiative, which is a focused effort that hopes to see gospel movements across the countries of Poland, the Czech Republic, and Slovakia. Steve also is the leader of the training and deployment team ensuring the global workers of Converge International Ministries are equipped for their specific ministries around the world.

Ivan Veldhuizen

Senior Vice President of International Ministries, Converge

Ivan Veldhuizen has served as the senior vice president of Converge International Ministries since 2012. He is working toward mobilizing churches to see least-reached people groups around the world come to faith in Christ.

Mark Venti

Executive Director of Generosity University, Overflow

Mark Venti is an innovative leader with more than two decades of experience in developing people, strategies, and systems in various contexts. As the executive director of Generosity University with Overflow, Mark specializes in building marketplace ministries and sustainable financial donor infrastructures. With a background as a pastor and executive leader, overseeing scaled multisite operations, he excels in scaling products and content strategies to expand reach within the modern church landscape. Additionally, Mark's expertise extends to team and leadership development, with a track record of building cohesive teams, setting departmental goals, and mentoring staff for high-level execution. As a skilled communicator, Mark has honed his craft under renowned speakers and is adept at galvanizing both staff and volunteers around a compelling vision.

Dr. Peter Vogt

Dean, Bethel Seminary

Dr. Peter Vogt serves as dean of Bethel Seminary, where he helps form radically countercultural followers of Jesus and helps others grow in the same. He earned his M.Div. from Bethel Seminary in 1997, then a Ph.D. in Old Testament from the University of Gloucestershire with a dissertation on Deuteronomy. Returning to Bethel in 2001, he rose from assistant professor to tenured full professor by 2014. From 2014 to 2018, he pastored a Converge church in Maplewood, Minnesota. He returned to Bethel as dean of Bethel Seminary in 2019, where he oversees academics, accreditation, online education, church partnerships, alumni support, and faculty supervision.

Nate Wagner

President, Actuator Leadership Group

Nate Wagner is president of Actuator Leadership Group, a counseling-coaching-consulting group dedicated to supporting missional leaders in ministry and the marketplace as they navigate the unique complexities of servant leadership.



**SCAN FOR FULL
BREAKOUT DETAILS**

PEER GROUPS

ROOM	PEER GROUP	LEADER
1305	Lead Pastors: 250 Members or Fewer	<i>Karl Vaters</i>
1211	Lead Pastors: 251–750 Members	<i>Andrew Ford</i>
2011-12	Lead Pastors: 751–1,500 Members	<i>Jason Allison</i>
2007-8	Lead Pastors: 1,500+ Members	<i>Paul Johnson</i>
1201	Church Planters: Prelaunch to 3 Years	<i>Marlan Mincks</i>
2107-8	Associate and Executive Pastors: 750 Members or Fewer	<i>Bryan Moak</i>
2111-12	Associate and Executive Pastors: 751+ Members	<i>Geoff Mann</i>
2311	Creative Ministry: Worship and Production	<i>Jenna Rooney and Kaleb Krueger</i>
SANCTUARY	Raising Up Volunteers for Your Ministry	<i>Chris Highfill</i>
CLC: CENTER COURT	Women in Ministry: Building Spiritual and Emotional Capacity	<i>Coletta Smith</i>
CLC: HALF COURT SOUTH	Here, Near, and Far: Evangelism and International Reach	<i>Steve Krier</i>

FIRST FLOOR

Where do I go?

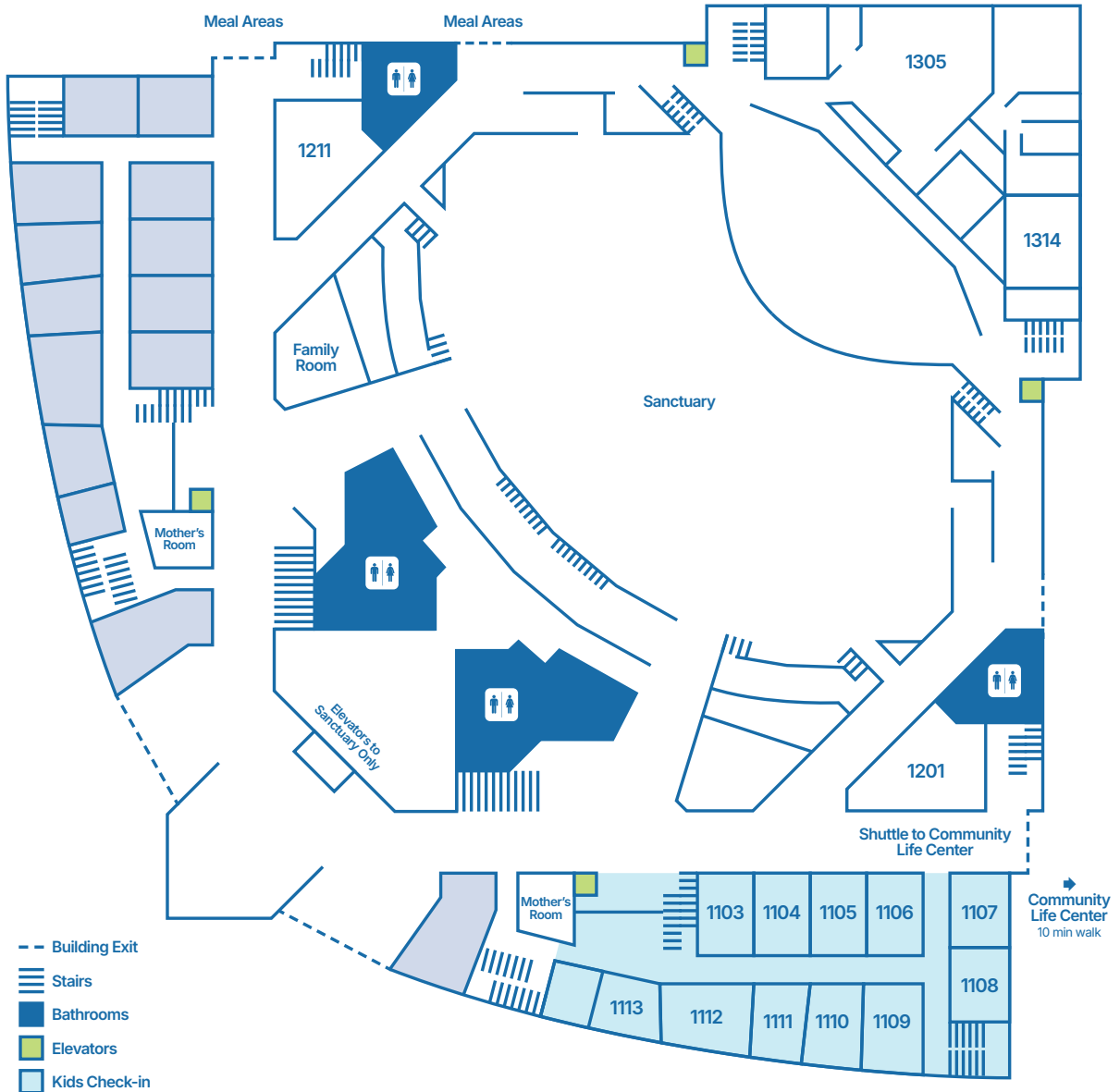

SECOND FLOOR

Where do I go?

